

OSMO

Straight Extension Arm

Quick Start Guide V1.0

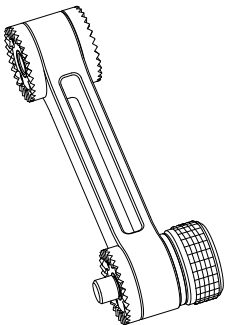

Disclaimer and Warning

Congratulations on purchasing your new DJI product. The information in this document affects your safety and your legal rights and responsibilities. Read this entire document carefully to ensure proper configuration before use. Failure to read and follow instructions and warnings in this document may result in serious injury to yourself or others, damage to your DJI product, or damage to other objects in the vicinity. This document and all other collateral documents are subject to change at the sole discretion of DJI. For up-to-date product information, visit <http://www.dji.com> and click on the product page for this product.

By using this product, you hereby signify that you have read this disclaimer and warning carefully and that you understand and agree to abide by the terms and conditions herein. You agree that you are solely responsible for your own conduct while using this product, and for any consequences thereof. You agree to use this product only for purposes that are proper and in accordance with all applicable laws, rules, and regulations, and all terms, precautions, practices, policies and guidelines DJI has made and may make available.

DJI accepts no liability for damage, injury or any legal responsibility incurred directly or indirectly from the use of this product. The user shall observe safe and lawful practices including, but not limited to, those set forth in this document.

Introduction

The Straight Extension Arm for the Osmo allows you to mount up to three other accessories at the same time. It comes with a short screw (for two mounts) and a long screw (for three mounts).

Specifications

Dimensions: 90 mm × 21 mm × 18 mm

Weight: 40 g

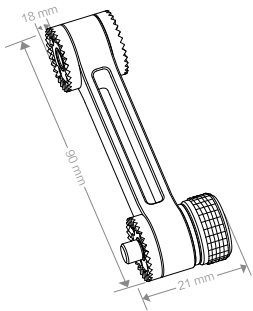

Installation

1. Attach the Straight Extension Arm to the rosette mount on the Osmo handle and tighten the knob to secure.

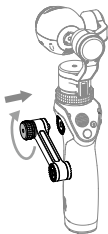

2. If you want to mount three accessories, install an extra rosette mount on the Straight Extension Arm and replace the short screw with the long screw.

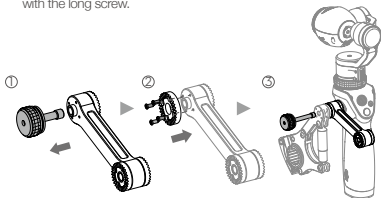

Suggested Combinations

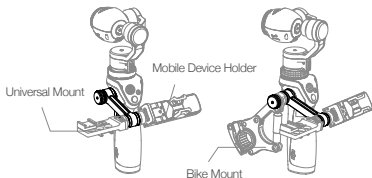

WARNING

Ensure the Straight Extension Arm and the extending mounts are secure and will not fall off.

This content is subject to change.

Download the latest version from
www.dji.com/product/osmo

If you have any questions about this document, please contact
DJI by sending a message to DocSupport@dji.com.